

PLEASE NOTE: The prices below are for reference only and are base models constructed of HPL work surfaces, TFL cabinets and doors with standard pulls, standard hinges and without locks. For detailed pricing please contact your local dealer or **mediatechnologies®**.

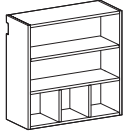

- 2 adjustable shelves

Wall Open Storage (WOS)		Melamine	High-Pressure Laminate		
Description	Wgt.	Model Number	List Price	Model Number	List Price
18"W x 14"D x 24"H	36	WOS-181424-T	\$449	WOS-181424-L	\$624
18"W x 14"D x 30"H	39	WOS-181430-T	\$452	WOS-181430-L	\$648
24"W x 14"D x 24"H	44	WOS-241424-T	\$455	WOS-241424-L	\$650
24"W x 14"D x 30"H	47	WOS-241430-T	\$466	WOS-241430-L	\$673
30"W x 14"D x 24"H	52	WOS-301424-T	\$493	WOS-301424-L	\$739
30"W x 14"D x 30"H	55	WOS-301430-T	\$500	WOS-301430-L	\$763
36"W x 14"D x 24"H	59	WOS-361424-T	\$539	WOS-361424-L	\$879
36"W x 14"D x 30"H	63	WOS-361430-T	\$559	WOS-361430-L	\$899
42"W x 14"D x 24"H	73	WOS-421424-T	\$624	WOS-421424-L	\$980
42"W x 14"D x 30"H	78	WOS-421430-T	\$640	WOS-421430-L	\$1,015



- 1 adjustable shelf
- 18" & 24" W units will have 2 lower cubbies
- 30" & 36" W will have 3 lower cubbies

Wall Open Storage with Cubicle Storage (WOSCB3)		Melamine	High-Pressure Laminate		
Description	Wgt.	Model Number	List Price	Model Number	List Price
18"W x 14"D x 30"H	39	WOSCB3-181430-T	\$489	WOSCB3-181430-L	\$721
24"W x 14"D x 30"H	47	WOSCB3-241430-T	\$497	WOSCB3-241430-L	\$748
30"W x 14"D x 30"H	58	WOSCB3-301430-T	\$519	WOSCB3-301430-L	\$794
36"W x 14"D x 30"H	67	WOSCB3-361430-T	\$596	WOSCB3-361430-L	\$978
42"W x 14"D x 30"H	82	WOSCB3-421430-T	\$717	WOSCB3-421430-L	\$1,200



- 2 adjustable shelves

Wall Cupboard Storage (WCS)		Melamine	High-Pressure Laminate		
Description	Wgt.	Model Number	List Price	Model Number	List Price
24"W x 14"D x 24"H	58	WCS-241424-TT-H?P?N	\$709	WCS-241424-LL-H?P?N	\$970
24"W x 14"D x 30"H	64	WCS-241430-TT-H?P?N	\$743	WCS-241430-LL-H?P?N	\$1,049
30"W x 14"D x 24"H	68	WCS-301424-TT-H?P?N	\$790	WCS-301424-LL-H?P?N	\$1,124
30"W x 14"D x 30"H	76	WCS-301430-TT-H?P?N	\$827	WCS-301430-LL-H?P?N	\$1,200
36"W x 14"D x 24"H	79	WCS-361424-TT-H?P?N	\$869	WCS-361424-LL-H?P?N	\$1,312
36"W x 14"D x 30"H	88	WCS-361430-TT-H?P?N	\$906	WCS-361430-LL-H?P?N	\$1,392
42"W x 14"D x 24"H	96	WCS-421424-TT-H?P?N	\$959	WCS-421424-LL-H?P?N	\$1,485
42"W x 14"D x 30"H	111	WCS-421430-TT-H?P?N	\$1,016	WCS-421430-LL-H?P?N	\$1,609



- 1 door hinged left
- 2 adjustable shelves

Wall Cupboard Storage Hinged Left (WCSL)		Melamine	High-Pressure Laminate		
Description	Wgt.	Model Number	List Price	Model Number	List Price
18"W x 14"D x 24"H	45	WCSL-181424-TT-H?P?N	\$589	WCSL-181424-LL-H?P?N	\$841
18"W x 14"D x 30"H	51	WCSL-181430-TT-H?P?N	\$620	WCSL-181430-LL-H?P?N	\$914
24"W x 14"D x 24"H	57	WCSL-241424-TT-H?P?N	\$632	WCSL-241424-LL-H?P?N	\$896
24"W x 14"D x 30"H	64	WCSL-241430-TT-H?P?N	\$743	WCSL-241430-LL-H?P?N	\$971

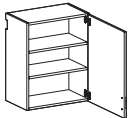

- 1 door hinged right
- 2 adjustable shelves

Wall Cupboard Storage Hinged Right (WCSR)		Melamine	High-Pressure Laminate		
Description	Wgt.	Model Number	List Price	Model Number	List Price
18"W x 14"D x 24"H	45	WCSR-181424-TT-H?P?N	\$589	WCSR-181424-LL-H?P?N	\$841
18"W x 14"D x 30"H	51	WCSR-181430-TT-H?P?N	\$620	WCSR-181430-LL-H?P?N	\$914
24"W x 14"D x 24"H	57	WCSR-241424-TT-H?P?N	\$632	WCSR-241424-LL-H?P?N	\$896
24"W x 14"D x 30"H	64	WCSR-241430-TT-H?P?N	\$743	WCSR-241430-LL-H?P?N	\$971

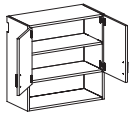

- 1 adjustable shelf

Wall Cupboard Storage with Open Storage (WCSOS)		Melamine	High-Pressure Laminate		
Description	Wgt.	Model Number	List Price	Model Number	List Price
24"W x 14"D x 24"H	58	WCSOS-241424-TT-H?P?N	\$803	WCSOS-241424-LL-H?P?N	\$1,074
24"W x 14"D x 30"H	64	WCSOS-241430-TT-H?P?N	\$848	WCSOS-241430-LL-H?P?N	\$1,154
30"W x 14"D x 24"H	68	WCSOS-301424-TT-H?P?N	\$896	WCSOS-301424-LL-H?P?N	\$1,232
30"W x 14"D x 30"H	76	WCSOS-301430-TT-H?P?N	\$934	WCSOS-301430-LL-H?P?N	\$1,307
36"W x 14"D x 24"H	79	WCSOS-361424-TT-H?P?N	\$979	WCSOS-361424-LL-H?P?N	\$1,420
36"W x 14"D x 30"H	88	WCSOS-361430-TT-H?P?N	\$1,015	WCSOS-361430-LL-H?P?N	\$1,496
42"W x 14"D x 24"H	100	WCSOS-421424-TT-H?P?N	\$1,062	WCSOS-421424-LL-H?P?N	\$1,589
42"W x 14"D x 30"H	111	WCSOS-421430-TT-H?P?N	\$1,117	WCSOS-421430-LL-H?P?N	\$1,738

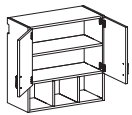

- 1 adjustable shelf
- 24" W units will have 2 lower cubbies
- 30" & 36" W units will have 3 lower cubbies

Wall Cupboard Storage with Open Cubicle Storage (WCSOCB3)		Melamine	High-Pressure Laminate		
Description	Wgt.	Model Number	List Price	Model Number	List Price
24"W x 14"D x 30"H	72	WCSOCB3-241430-TT-H?P?N	\$1,031	WCSOCB3-241430-LL-H?P?N	\$1,094
30"W x 14"D x 30"H	79	WCSOCB3-301430-TT-H?P?N	\$1,144	WCSOCB3-301430-LL-H?P?N	\$1,246
36"W x 14"D x 30"H	92	WCSOCB3-361430-TT-H?P?N	\$1,244	WCSOCB3-361430-LL-H?P?N	\$1,437

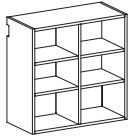

- 1 fixed partition
- 4 adjustable shelves

Wall Cubicle Storage - 6 Cubicles (WOCB6)		Melamine	High-Pressure Laminate		
Description	Wgt.	Model Number	List Price	Model Number	List Price
18"W x 14"D x 24"H	38	WOCB6-181424-T	\$489	WOCB6-181424-L	\$716
18"W x 14"D x 30"H	41	WOCB6-181430-T	\$518	WOCB6-181430-L	\$785
24"W x 14"D x 24"H	47	WOCB6-241424-T	\$497	WOCB6-241424-L	\$739
24"W x 14"D x 30"H	50	WOCB6-241430-T	\$531	WOCB6-241430-L	\$811
30"W x 14"D x 24"H	55	WOCB6-301424-T	\$570	WOCB6-301424-L	\$866
30"W x 14"D x 30"H	58	WOCB6-301430-T	\$598	WOCB6-301430-L	\$933
36"W x 14"D x 24"H	64	WOCB6-361424-T	\$629	WOCB6-361424-L	\$1,004
36"W x 14"D x 30"H	67	WOCB6-361430-T	\$652	WOCB6-361430-L	\$1,068
42"W x 14"D x 24"H	78	WOCB6-421424-T	\$640	WOCB6-421424-L	\$1,017
42"W x 14"D x 30"H	82	WOCB6-421430-T	\$670	WOCB6-421430-L	\$1,086
48"W x 14"D x 24"H	87	WOCB6-481424-T	\$643	WOCB6-481424-L	\$1,017
48"W x 14"D x 30"H	92	WOCB6-481430-T	\$671	WOCB6-481430-L	\$1,087



- 2 fixed vertical partitions
- 6 adjustable shelves

Wall Cubicle Storage - 9 Cubicles (WOCB9)		Melamine	High-Pressure Laminate		
Description	Wgt.	Model Number	List Price	Model Number	List Price
18"W x 14"D x 24"H	41	WOCB9-181424-T	\$491	WOCB9-181424-L	\$717
18"W x 14"D x 30"H	44	WOCB9-181430-T	\$519	WOCB9-181430-L	\$786
24"W x 14"D x 24"H	52	WOCB9-241424-T	\$500	WOCB9-241424-L	\$740
24"W x 14"D x 30"H	55	WOCB9-241430-T	\$532	WOCB9-241430-L	\$812
30"W x 14"D x 24"H	62	WOCB9-301424-T	\$571	WOCB9-301424-L	\$867
30"W x 14"D x 30"H	65	WOCB9-301430-T	\$600	WOCB9-301430-L	\$936
36"W x 14"D x 24"H	72	WOCB9-361424-T	\$630	WOCB9-361424-L	\$1,005
36"W x 14"D x 30"H	75	WOCB9-361430-T	\$657	WOCB9-361430-L	\$1,069
42"W x 14"D x 24"H	87	WOCB9-421424-T	\$643	WOCB9-421424-L	\$1,019
42"W x 14"D x 30"H	92	WOCB9-421430-T	\$671	WOCB9-421430-L	\$1,087
48"W x 14"D x 24"H	98	WOCB9-481424-T	\$644	WOCB9-481424-L	\$1,019
48"W x 14"D x 30"H	103	WOCB9-481430-T	\$671	WOCB9-481430-L	\$1,089

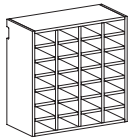

- 3 fixed vertical partitions
- 32 fixed shelves

Wall Cubicle Mail Storage (WOCBM)		Melamine	High-Pressure Laminate		
Description	Wgt.	Model Number	List Price	Model Number	List Price
30"W x 14"D x 30"H	72	WOCBM-301430-T	\$837	WOCBM-301430-L	\$1,412
36"W x 14"D x 30"H	83	WOCBM-361430-T	\$970	WOCBM-361430-L	\$1,688



- 1 fixed vertical partition
- 4 adjustable shelves

Wall Cupboard Cubicle Storage - 6 Cubicles (WCCB6)		Melamine	High-Pressure Laminate		
Description	Wgt.	Model Number	List Price	Model Number	List Price
18"W x 14"D x 24"H	50	WCCB6-181424-TT-H?P?N	\$997	WCCB6-181424-LL-H?P?N	\$1,015
18"W x 14"D x 30"H	56	WCCB6-181430-TT-H?P?N	\$1,030	WCCB6-181430-LL-H?P?N	\$1,071
24"W x 14"D x 24"H	63	WCCB6-241424-TT-H?P?N	\$1,058	WCCB6-241424-LL-H?P?N	\$1,069
24"W x 14"D x 30"H	70	WCCB6-241430-TT-H?P?N	\$1,113	WCCB6-241430-LL-H?P?N	\$1,133
30"W x 14"D x 24"H	75	WCCB6-301424-TT-H?P?N	\$1,117	WCCB6-301424-LL-H?P?N	\$1,190
30"W x 14"D x 30"H	83	WCCB6-301430-TT-H?P?N	\$1,148	WCCB6-301430-LL-H?P?N	\$1,245
36"W x 14"D x 24"H	87	WCCB6-361424-TT-H?P?N	\$1,193	WCCB6-361424-LL-H?P?N	\$1,372
36"W x 14"D x 30"H	96	WCCB6-361430-TT-H?P?N	\$1,245	WCCB6-361430-LL-H?P?N	\$1,432
42"W x 14"D x 24"H	105	WCCB6-421424-TT-H?P?N	\$1,270	WCCB6-421424-LL-H?P?N	\$1,463
42"W x 14"D x 30"H	116	WCCB6-421430-TT-H?P?N	\$1,321	WCCB6-421430-LL-H?P?N	\$1,546
48"W x 14"D x 24"H	118	WCCB6-481424-TT-H?P?N	\$1,273	WCCB6-481424-LL-H?P?N	\$1,464
48"W x 14"D x 30"H	130	WCCB6-481430-TT-H?P?N	\$1,322	WCCB6-481430-LL-H?P?N	\$1,547



- 2 fixed vertical partitions
- 6 adjustable shelves

Wall Cupboard Cubicle Storage - 9 Cubicles (WCCB9)		Melamine	High-Pressure Laminate		
Description	Wgt.	Model Number	List Price	Model Number	List Price
18"W x 14"D x 24"H	54	WCCB9-181424-TT-H?P?N	\$1,003	WCCB9-181424-LL-H?P?N	\$1,017
18"W x 14"D x 30"H	59	WCCB9-181430-TT-H?P?N	\$1,031	WCCB9-181430-LL-H?P?N	\$1,074
24"W x 14"D x 24"H	68	WCCB9-241424-TT-H?P?N	\$1,059	WCCB9-241424-LL-H?P?N	\$1,071
24"W x 14"D x 30"H	75	WCCB9-241430-TT-H?P?N	\$1,091	WCCB9-241430-LL-H?P?N	\$1,135
30"W x 14"D x 24"H	82	WCCB9-301424-TT-H?P?N	\$1,124	WCCB9-301424-LL-H?P?N	\$1,193
30"W x 14"D x 30"H	89	WCCB9-301430-TT-H?P?N	\$1,149	WCCB9-301430-LL-H?P?N	\$1,246
36"W x 14"D x 24"H	111	WCCB9-361424-TT-H?P?N	\$1,195	WCCB9-361424-LL-H?P?N	\$1,375
36"W x 14"D x 30"H	104	WCCB9-361430-TT-H?P?N	\$1,247	WCCB9-361430-LL-H?P?N	\$1,433
42"W x 14"D x 24"H	115	WCCB9-421424-TT-H?P?N	\$1,273	WCCB9-421424-LL-H?P?N	\$1,464
42"W x 14"D x 30"H	126	WCCB9-421430-TT-H?P?N	\$1,322	WCCB9-421430-LL-H?P?N	\$1,547
48"W x 14"D x 24"H	129	WCCB9-481424-TT-H?P?N	\$1,280	WCCB9-481424-LL-H?P?N	\$1,465
48"W x 14"D x 30"H	141	WCCB9-481430-TT-H?P?N	\$1,323	WCCB9-481430-LL-H?P?N	\$1,552

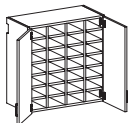

- 3 fixed vertical partitions
- 32 fixed shelves

Wall Cupboard Cubicle Mail Storage (WCCBM)		Melamine	High-Pressure Laminate		
Description	Wgt.	Model Number	List Price	Model Number	List Price
30"W x 14"D x 30"H	96	WCCBM-301430-TT-H?P?N	\$1,640	WCCBM-301430-LL-H?P?N	\$1,883
36"W x 14"D x 30"H	112	WCCBM-361430-TT-H?P?N	\$1,825	WCCBM-361430-LL-H?P?N	\$2,218

P-ELEMENTSWALL-230101



- 1 fixed vertical partition
- 20 fixed shelves

Wall Open Folio Storage (WOF)		Melamine	High-Pressure Laminate		
Description	Wgt.	Model Number	List Price	Model Number	List Price
20"W x 14"D x 24"H	52	WOF-201424-T	\$894	WOF-201424-L	\$1,071
20"W x 14"D x 30"H	55	WOF-201430-T	\$919	WOF-201430-L	\$1,139
30"W x 14"D x 24"H	62	WOF-301424-T	\$1,006	WOF-301424-L	\$1,213
30"W x 14"D x 30"H	65	WOF-301430-T	\$1,037	WOF-301430-L	\$1,283
36"W x 14"D x 24"H	72	WOF-361424-T	\$1,105	WOF-361424-L	\$1,357
36"W x 14"D x 30"H	75	WOF-361430-T	\$1,131	WOF-361430-L	\$1,425



- 1 fixed vertical partition
- 20 fixed shelves

Wall Cupboard Folio Storage (WCF)		Melamine	High-Pressure Laminate		
Description	Wgt.	Model Number	List Price	Model Number	List Price
20"W x 14"D x 24"H	68	WCF-201424-TT-H?P?N	\$1,303	WCF-201424-LL-H?P?N	\$1,220
20"W x 14"D x 30"H	75	WCF-201430-TT-H?P?N	\$1,355	WCF-201430-LL-H?P?N	\$1,312
30"W x 14"D x 24"H	82	WCF-301424-TT-H?P?N	\$1,468	WCF-301424-LL-H?P?N	\$1,386
30"W x 14"D x 30"H	89	WCF-301430-TT-H?P?N	\$1,514	WCF-301430-LL-H?P?N	\$1,475
36"W x 14"D x 24"H	95	WCF-361424-TT-H?P?N	\$1,616	WCF-361424-LL-H?P?N	\$1,580
36"W x 14"D x 30"H	104	WCF-361430-TT-H?P?N	\$1,661	WCF-361430-LL-H?P?N	\$1,671

#### Set Up Charges and Upcharges for Non-Standard and Custom Finishes

Model Number	Description	List Price
Group 2 Powder Coat	Set up charge, per color, per order, for Group 2 Powder Coat	\$312
Non-Standard PVC	Upcharge, per color, per order, for non-standard PVC	\$865

## TERMS & CONDITIONS

**Prices:** All prices are F.O.B. the factory. Prices and specifications are subject to change without notice. Prices do not include applicable taxes, special handling or installation charges. Possession of a price list is not an offer to or agreement to sell. We reserve the right to change prices without notice. We are not responsible for typographical errors. In the event a price or description is found to be incorrect, the correct information will be communicated to you when the order is received.

**Credit Terms:** Open account status is only granted after a completed credit application is received and approved.

**Payment Terms:** Terms for open account are net 30 days. Terms for orders without open account will be determined by Silver Street, Incorporated on an order-by-order basis and may require prepayment or a 50% deposit with order and the balance prepaid before shipment.

**Orders:** Orders must be in writing. Faxed orders are acceptable. Processing of orders will not begin until a signed acknowledgment is received.

**Acknowledgments:** Orders are accepted, manufactured and invoiced based on written acknowledgments issued by Silver Street, Incorporated. All orders are considered correct as acknowledged. Notify Silver Street, Incorporated immediately of any order discrepancies. Acknowledged orders may not be changed or canceled without written consent from Silver Street, Incorporated.

**Changes to orders:** Changes to orders already in process may be subject to a fee covering the cost to make the requested change. If a fee is necessary a written authorization of acceptance will be required. All requests for changes are subject to approval by Silver Street, Incorporated.

**Cancellation of orders:** All orders received by Silver Street, Incorporated are considered firm and cannot be canceled without our approval. A cancellation fee may be required based upon cost incurred by Silver Street, Incorporated prior to receipt of a cancellation request.

**Returns:** Returns are not accepted without a Return Goods Authorization issued by Silver Street, Incorporated. Unauthorized returns will not be accepted. Returns may be subject to a restocking fee.

**Shipping Terms:** All orders will be shipped F.O.B. shipping point with freight charged collect. Shipping weights listed are net.

**Routing:** Shipments will be routed "best way" or as specified. Instructions will be followed as closely as possible, however, Silver Street, Incorporated reserves the right to make changes due to local conditions or other circumstances.

**Freight Damage:** Legal title to merchandise passes to the buyer upon acceptance by the carrier. All cartons must be carefully inspected at the time of delivery. Visible damage should be noted on the delivery receipt. In the case of concealed damage, the carrier must be notified within (5) days. It is the buyer's obligation to seek recourse against the shipper.

**Shortages:** Shipments should be inspected upon receipt for shortages. Shortages must be reported to Silver Street, Incorporated in writing within (5) days of receipt.

**Shipping Address:** **mediatechnologies®**  
892 Industrial Park Drive  
Shelby, MI 49455

**Warranty:** All items manufactured by Silver Street, Incorporated, home of mediatechnologies® and Elements by mediatechnologies are guaranteed against defects for a period of five (5) years from the date of purchase. We will repair or replace, in our discretion, any defective item without cost to our customer. This is customer's sole and exclusive remedy against us. No delay in shipment or delivery shall give rise to any liability for damages whatsoever. We are not liable for defects caused by customer or any third party. Customer is not authorized to make any repairs whatsoever or to deduct any amount from the purchase price. In no event shall our liability under this warranty exceed the purchase price. In no event shall we be liable for incidental, special or consequential damages. We disclaim all other warranties, express or implied, as to any matter whatsoever, including without limitation, quality, design, performance, specifications, samples, condition, merchantability and fitness for any particular purpose. No action may be commenced for breach of the warranty more than six months after the cause of action accrues and any such action may only be brought in the county of Oceana, State of Michigan.

**elements**

by mediatechnologies®

is a registered trademark of Silverstreet Incorporated.

U.S. Patent # 8,434,835 B2

P-ELEMENTSWALL-230101