

General Specifications

Cabinet Construction: Cabinets are constructed with 3/4" thick engineered wood core side panels, sub-tops, vertical dividers and shelves. Base cabinet bottoms and all adjustable shelves over 36" in length are 1" thick engineered wood core. 1/4" thick cabinet backs. Dowel pinned structural 3/4" stringers add rigidity. Sliding marker boards reveal adjustable shelves behind.

Box and front finish is available in melamine, high-pressure laminate and oak or maple veneers. Box edge is .5mm PVC. Front edge is 3mm PVC for melamine and high-pressure laminate or 3mm wood for veneer finishes.

Drawers: 3/4 or full-extension drawers are available

Hinges and Pulls: 5-knuckle, 3-knuckle, concealed and piano-style hinges are available. Wire pulls, Loop pulls, Curve Pulls and 6" bar pulls are available. Wire, Loop and Curve pulls are available in Nickel finish. Bar pull is available in stainless. Wire pull and Loop pull are also available in Black.

Finish: Standard powder coat on all metal parts is black; other colors may be specified.

See mediatechnologies® Finish and Color Guide for choices.

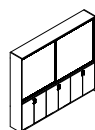
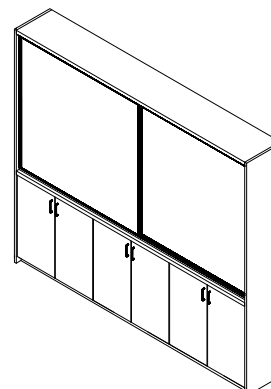

| Free Standing eWall™ Thermally Fused Laminate | | | | |
|---|---|-----|------------|--|
| Model Number | Description | Wgt | List Price | |
| SBCS-011T-20 | Base Cupboard w/ Marker Boards & Upper Storage, 92"W x 20"D x 84"H | 515 | \$8,015 | |
| SBCS-011T-24 | Base Cupboard w/ Marker Boards & Upper Storage, 92"W x 24"D x 84"H | 520 | \$8,395 | |
| SBCS-012T-20 | Base Cupboard w/ Marker Boards & Upper Storage & Tall Cabinets, 126"W x 20"D x 84"H | 615 | \$10,103 | |
| SBCS-012T-24 | Base Cupboard w/ Marker Boards & Upper Storage & Tall Cabinets, 126"W x 24"D x 84"H | 620 | \$10,509 | |
| SBCSD-011T-20 | Base Drawer & Cupboard w/ Marker Boards & Upper Storage, 92"W x 20"D x 84"H | 518 | \$9,092 | |
| SBCSD-011T-24 | Base Drawer & Cupboard w/ Marker Boards & Upper Storage, 92"W x 24"D x 84"H | 523 | \$9,466 | |
| SBCSD-012T-20 | Base Drawer & Cupboard w/ Marker Boards & Upper Storage & Tall Cabinet, 126"W x 20"D x 84"H | 618 | \$9,675 | |
| SBCSD-012T-24 | Base Drawer & Cupboard w/ Marker Boards & Upper Storage & Tall Cabinet, 126"W x 24"D x 84"H | 623 | \$11,257 | |

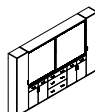
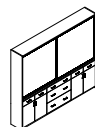
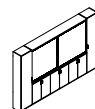

Available Drawer/Cabinet Pulls

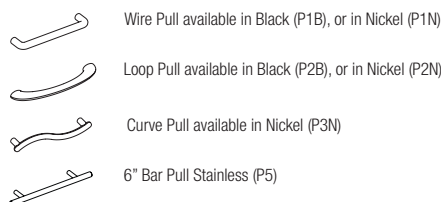

Required to order: Model # including options if applicable

- melamine selection
- PVC Selection
- hinge selection
- pull selection and color

Note: Please contact the factory for high pressure laminate and veneer pricing.