

Modular Circulations Desks

General Specifications - Circulation Desks

Modular Case System: Each case module is fully assembled, allowing for simple field assembly of the complete circulation desk as well as for easy reconfiguration, if necessary. Cases connect with male/female threaded metal connectors.

Top: Tops are 1-1/4" thick, three ply engineered wood construction with .050" High pressure laminate, HPL, and a phenolic backer sheet. The patron side is edged with 5/16" x 1-1/4" solid red oak (with the exception on the Malibu and Keystone design have 1-5/8") with a 1/4" radius top and bottom. The edges and back side of the top are edged with 1/8" solid red oak.

Case Construction: Circulation desk modules are constructed of 3/4" thick, three ply particleboard with plain sliced "A" grade oak veneer. All modules, except Malibu style, utilize a continuous front design (sides do not penetrate), with a 4" High recessed toe. Cabinets are assembled using glue and dowel joinery. Note: One Terminating End Panel is required for each exposed end of a complete desk assembly. Terminating end panels are available to create right or left facing units. Right side and left side is determined from the perspective of the desk user.

Adjustable Shelves: Adjustable shelves are 3/4" thick three ply particleboard plywood with "A" grade oak veneer faces. The exposed edges are edged with 1/8" solid red oak. Shelves are adjustable on 32mm increments.

Drawers: Drawers are constructed of 1/2" nine ply baltic birch plywood. Drawers have 3/4" thick fronts with "A" grade oak veneer. Box drawers have 100 lb. full extension slides, file drawers have 100 lb. full extension slides.

Doors: Doors are constructed of 3/4" thick, three ply particleboard with plain sliced "A" grade oak veneer faces and edged on all sides with 1/8" solid red oak. Door hardware includes concealed hinges, fully adjustable in all 3 axes, and wire pulls.

Continuous Top Construction: Tops may be specified as continuous.

Locks: Units may be specified with doors and or drawers locking, keyed random or alike.

Design Lines: mediatechnologies® offers seven design lines of circulation desk modules, all using the general construction specifications above.

To specify a design line you must include a letter indicator: No letter indicator will specify our standard Bookmark design.

M-Metro **L**-Lexington **H**-Heritage **MB**-Malibu
CL-Charleston **KS**-Keystone

Please see below for design descriptions

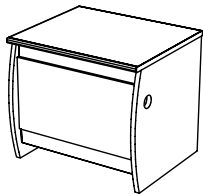

Malibu: a modern style design using curved end panels with laminate inlay details at top and bottom applied to the patron side of most modular units.

Model Number example for

Malibu Desk unit;
MCD-MB-36D-29

Malibu

Circulation Desks

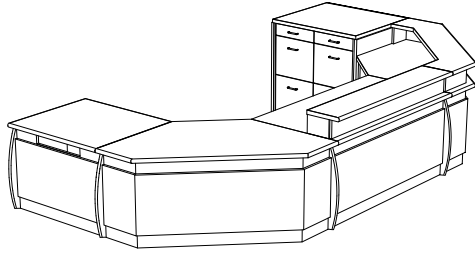

Desk Units				
36" Wide	Model Number	Description	Wgt.	List Price
	MCD-MB-36D-29	Desk Unit, 36"W X 30"D X 29" H	120	\$3,859
	MCD-MB-36D-32	Desk Unit, 36"W X 30"D X 32" H	126	\$3,859
	MCD-MB-36D-39	Desk Unit, 36"W X 30"D X 39" H	141	\$4,003
	MCD-MB-36D-32-ADJ	Desk Unit, 36"W X 30"D X ADJ. H	126	\$4,200
48" Wide	Model Number	Description	Wgt.	List Price
	MCD-MB-48D-29	Desk Unit, 48"W X 30"D X 29" H	131	\$5,139
	MCD-MB-48D-32	Desk Unit, 48"W X 30"D X 32" H	138	\$5,139
	MCD-MB-48D-39	Desk Unit, 48"W X 30"D X 39" H	153	\$5,446
	MCD-MB-48D-32-ADJ	Desk Unit, 48"W X 30"D X ADJ. H	138	\$5,598
72" Wide	Model Number	Description	Wgt.	List Price
	MCD-MB-72D-29	Desk Unit, 72"W X 30"D X 29" H	206	\$6,453
	MCD-MB-72D-32	Desk Unit, 72"W X 30"D X 32" H	212	\$6,453
	MCD-MB-72D-39	Desk Unit, 72"W X 30"D X 39" H	230	\$6,474
	MCD-MB-72D-32-ADJ	Desk Unit, 72"W X 30"D X ADJ. H	212	\$7,030
Book Return	Model Number	Description	Wgt.	List Price
	MCD-MB-36BR-29	Book Return, 36"W X 30"D X 29" H	118	\$4,026
	MCD-MB-36BR-32	Book Return, 36"W X 30"D X 32" H	124	\$4,026
	MCD-MB-36BR-39	Book Return, 36"W X 30"D X 39" H	139	\$4,171
Descending Platform BookTruck	Model Number	Description	Wgt.	List Price
	MCD-DBT-1824-21	Depressible Platform Book Truck, 18"D x 24.25"W x 21"H, For curved 29"H Book Return Units and Nomad Book Return	135	\$2,982
	MCD-DBT-1824-24	Depressible Platform Book Truck, 18"D x 24.25"W x 24"H, For Curved 32"-39"H Book Return Units	135	\$2,982
	MCD-DBT-2424-21	Depressible Platform Book Truck, 23.625"D x 24.25"W x 21"H, For 29"H Book Return Units with Extended Chutes and 32"H Keystone and Malibu Book Returns	137	\$2,982
	MCD-DBT-2424-24	Depressible Platform Book Truck, 23.625"D x 24.25"W x 24"H, For 32" and #1"H Book Return Units	137	\$2,982
Top Surface Slot Book Return Module with Drawer and Shelf Storage	Model Number	Description	Wgt.	List Price
	MCD-MB-36SBR-TOP-29	Book Return w Top Slot, 36"W X 30"D X 29" H	200	\$5,143
	MCD-MB-36SBR-TOP-32	Book Return w Top Slot, 36"W X 30"D X 32" H	204	\$5,143
	MCD-MB-36SBR-TOP-39	Book Return w Top Slot, 36"W X 30"D X 39" H	218	\$5,175
Cupboard Units	Model Number	Description	Wgt.	List Price
	MCD-MB-36CS-29	Cupboard Unit, 36"W X 30"D X 29" H	189	\$5,063
	MCD-MB-36CS-32	Cupboard Unit, 36"W X 30"D X 32" H	192	\$5,063
	MCD-MB-36CS-39	Cupboard Unit, 36"W X 30"D X 39" H	210	\$5,097
Cupboard Unit With Drawer	Model Number	Description	Wgt.	List Price
	MCD-MB-36CD-29	Cupboard Unit, 36"W X 30"D X 29" H with drawer	201	\$5,595
	MCD-MB-36CD-32	Cupboard Unit, 36"W X 30"D X 32" H with drawer	207	\$5,595
	MCD-MB-36CD-39	Cupboard Unit, 36"W X 30"D X 39" H with drawer	225	\$5,624

Circulation Desks

Cupboard Unit With 2 & 3 Drawers (Cupboard Left)	Model Number	Description	Wgt.	List Price
	MCD-MB-36C2DL-29	Cupboard Unit, Left, 36"W X 30"D X 29" H with 2 drawers, file/file	222	\$6,713
	MCD-MB-36C2DL-32	Cupboard Unit, Left, 36"W X 30"D X 32" H with 2 drawers, file/file	225	\$6,713
	MCD-MB-36C3DL-32	Cupboard Unit, Left, 36"W X 30"D X 32" H with 3 drawers, box/box/file	230	\$6,924
	MCD-MB-36C3DL-39	Cupboard Unit, Left, 36"W X 30"D X 39" H with 3 drawers, box/file/file	256	\$6,971
Cupboard Unit With 2 & 3 Drawers (Cupboard Right)	Model Number	Description	Wgt.	List Price
	MCD-MB-36C2DR-29	Cupboard Unit, Right, 36"W X 30"D X 29" H with 2 drawers, file/file	222	\$6,713
	MCD-MB-36C2DR-32	Cupboard Unit, Right, 36"W X 30"D X 32" H with 2 drawers, file/file	225	\$6,713
	MCD-MB-36C3DR-32	Cupboard Unit, Right, 36"W X 30"D X 32" H with 3 drawers, box/box/file	230	\$6,924
	MCD-MB-36C3DR-39	Cupboard Unit, Right, 36"W X 30"D X 39" H with 3 drawers, box/file/file	256	\$6,971
Cupboard Unit With Open Storage (Cupboard Left)	Model Number	Description	Wgt.	List Price
	MCD-MB-36COSL-29	Cupboard Unit, Left, 36"W X 30"D X 29" H with open storage	186	\$5,229
	MCD-MB-36COSL-32	Cupboard Unit, Left, 36"W X 30"D X 32" H with open storage	190	\$5,229
	MCD-MB-36COSL-39	Cupboard Unit, Left, 36"W X 30"D X 39" H with open storage	204	\$5,279
Cupboard Unit With Open Storage (Cupboard Right)	Model Number	Description	Wgt.	List Price
	MCD-MB-36COSR-29	Cupboard Unit, Right, 36"W X 30"D X 29" H with open storage	186	\$5,229
	MCD-MB-36COSR-32	Cupboard Unit, Right, 36"W X 30"D X 32" H with open storage	190	\$5,229
	MCD-MB-36COSR-39	Cupboard Unit, Right, 36"W X 30"D X 39" H with open storage	204	\$5,279
Open Storage Units	Model Number	Description	Wgt.	List Price
	MCD-MB-36OS-29	Open Storage, 36"W X 30"D X 29" H	185	\$4,364
	MCD-MB-36OS-32	Open Storage, 36"W X 30"D X 32" H	189	\$4,364
	MCD-MB-36OS-39	Open Storage, 36"W X 30"D X 39" H	202	\$4,387
Open Storage Unit With Drawer	Model Number	Description	Wgt.	List Price
	MCD-MB-36OSD-29	Open Storage, 36"W X 30"D X 29" H with drawer	200	\$5,007
	MCD-MB-36OSD-32	Open Storage, 36"W X 30"D X 32" H with drawer	204	\$5,007
	MCD-MB-36OSD-39	Open Storage, 36"W X 30"D X 39" H with drawer	218	\$5,038
Open Storage Unit With 2 & 3 Drawers (Open Storage Left)	Model Number	Description	Wgt.	List Price
	MCD-MB-36OS2DL-29	Open Storage, Left, 36"W X 30"D X 29" H with 2 drawers, file/file	209	\$6,589
	MCD-MB-36OS2DL-32	Open Storage, Left, 36"W X 30"D X 32" H with 2 drawers, file/file	212	\$6,589
	MCD-MB-36OS3DL-32	Open Storage, Left, 36"W X 30"D X 32" H with 3 drawers, box/box/file	220	\$6,758
	MCD-MB-36OS3DL-39	Open Storage, Left, 36"W X 30"D X 39" H with 3 drawers, box/file/file	240	\$6,986
Open Storage Unit With 2 & 3 Drawers (Open Storage Right)	Model Number	Description	Wgt.	List Price
	MCD-MB-36OS2DR-29	Open Storage, Right, 36"W X 30"D X 29" H with 2 drawers, file/file	209	\$6,589
	MCD-MB-36OS2DR-32	Open Storage, Right, 36"W X 30"D X 32" H with 2 drawers, file/file	212	\$6,589
	MCD-MB-36OS3DR-32	Open Storage, Right, 36"W X 30"D X 32" H with 3 drawers, box/box/file	220	\$6,758
	MCD-MB-36OS3DR-39	Open Storage, Right, 36"W X 30"D X 39" H with 3 drawers, box/file/file	240	\$6,986

Malibu

Circulation Desks

Kneespace Unit	Model Number	Description	Wgt.	List Price
	MCD-MB-36KS-32	Kneespace Unit, 36"W X 30"D X 32" H	138	\$4,799
	MCD-MB-36KS-39	Kneespace Unit, 36"W X 30"D X 39" H	151	\$4,832
Corner Units				
45 Degree Radius	Model Number	Description	Wgt.	List Price
	MCD-MB-30RC45-29	Radius Corner, 30"W X 30"D X 29" H	74	\$4,631
	MCD-MB-30RC45-32	Radius Corner, 30"W X 30"D X 32" H	77	\$4,631
	MCD-MB-30RC45-39	Radius Corner, 30"W X 30"D X 39" H	84	\$5,078
45 Degree Flat	Model Number	Description	Wgt.	List Price
	MCD-MB-30FC45-29	Flat Corner, 30"W X 30"D X 29"H	74	\$4,768
	MCD-MB-30FC45-32	Flat Corner, 30"W X 30"D X 32"H	77	\$4,768
	MCD-MB-30FC45-39	Flat Corner, 30"W X 30"D X 39"H	84	\$5,229
90 Degree Radius	Model Number	Description	Wgt.	List Price
	MCD-MB-30RC-29	Radius Corner, 30"W X 30"D X 29" H	148	\$5,083
	MCD-MB-30RC-32	Radius Corner, 30"W X 30"D X 32" H	153	\$5,083
	MCD-MB-30RC-39	Radius Corner, 30"W X 30"D X 39" H	168	\$5,250
90 Degree Radius with Shelves	Model Number	Description	Wgt.	List Price
	MCD-MB-30RCS-29	Radius Corner, 30"W X 30"D X 29" H	158	\$6,165
	MCD-MB-30RCS-32	Radius Corner, 30"W X 30"D X 32" H	163	\$6,165
	MCD-MB-30RCS-39	Radius Corner, 30"W X 30"D X 39" H	178	\$6,328
90 Degree Extended Radius	Model Number	Description	Wgt.	List Price
	MCD-MB-30ERC-29	Radius Ext. Corner, 66"W X 34"D X 29" H	276	\$8,916
	MCD-MB-30ERC-32	Radius Ext. Corner, 66"W X 34"D X 32" H	284	\$8,916
	MCD-MB-30ERC-39	Radius Ext. Corner, 66"W X 34"D X 39" H	306	\$9,097
90 Degree Extended Flat	Model Number	Description	Wgt.	List Price
	MCD-MB-30EFC-29	Flat Corner, 66"W X 30"D X 29" H extended unit	226	\$7,092
	MCD-MB-30EFC-32	Flat Corner, 66"W X 30"D X 32" H extended unit	232	\$7,092
	MCD-MB-30EFC-39	Flat Corner, 66"W X 30"D X 39" H extended unit	250	\$7,294
90 Degree Square	Model Number	Description	Wgt.	List Price
	MCD-MB-30SC-29	Square Corner, 30"W X 30"D X 29"H	152	\$3,898
	MCD-MB-30SC-32	Square Corner, 30"W X 30"D X 32"H	155	\$3,898
	MCD-MB-30SC-39	Square Corner, 30"W X 30"D X 39"H	170	\$4,039
Triangle Corner Unit	Model Number	Description	Wgt.	List Price
	MCD-MB-30TC-29	Triangle Corner, 30"W X 30"D X 29" H	88	\$3,898
	MCD-MB-30TC-32	Triangle Corner, 30"W X 30"D X 32" H	91	\$3,898
	MCD-MB-30TC-39	Triangle Corner, 30"W X 30"D X 39" H	98	\$4,053
Triangle Corner Unit with Shelves	Model Number	Description	Wgt.	List Price
	MCD-MB-30TCS-29	Triangle Corner, 30"W X 30"D X 29" H with shelves	87	\$3,597
	MCD-MB-30TCS-32	Triangle Corner, 30"W X 30"D X 32" H with shelves	89	\$3,597
	MCD-MB-30TCS-39	Triangle Corner, 30"W X 30"D X 39" H with shelves	97	\$3,742

* Note: For Triangle Corner Unit with Shelves, use Bookmark MCD-TCS units.

Circulation Desk End Panels

Note: One Terminating End Panel is required for each exposed end of a complete desk assembly. End Panels are available in all standard design lines. Terminating end panels are available to create right or left facing units. Right side and left side is determined from the perspective of the desk user.

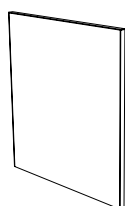

Malibu	Model Number	Description	Wgt.	Price
	MCD-MB-29EP-LH	Malibu Finished End Panel for 29"H Unit	19	\$805
	MCD-MB-29EP-RH	Malibu Finished End Panel for 29"H Unit	19	\$805
	MCD-MB-32EP-LH	Malibu Finished End Panel for 32"H Unit	20	\$805
	MCD-MB-32EP-RH	Malibu Finished End Panel for 32"H Unit	20	\$805
	MCD-MB-39EP-LH	Malibu Finished End Panel for 39"H Unit	24	\$918
	MCD-MB-39EP-RH	Malibu Finished End Panel for 39"H Unit	24	\$918

Mobile Pedestals	Model Number	Description	Wgt.	List Price
	WMP661222	6/6/12 X 22" D Mobile Pedestal, steel with steel fronts	42	\$924
	WMP121222	12/12 X 22" D Mobile Pedestal, steel with steel fronts	38	\$830
	WMP661222-SW	6/6/12 X 22" D Mobile Pedestal, steel with wood fronts	54	\$1,584
	WMP121222-SW	12/12 X 22" D Mobile Pedestal, steel with wood fronts	50	\$1,488
	WMP661222-W	6/6/12 X 22" D Mobile Pedestal, wood with wood fronts	66	\$1,584
	WMP121222-W	12/12 X 22" D Mobile Pedestal, wood with wood fronts	62	\$1,488



WKS Supporting Pedestals	Model Number	Description	Wgt.	List Price
	WP661222	6/6/12 X 22" D WKS Supporting Ped, steel with steel fronts	46	\$898
	WP121222	12/12 X 22" D WKS Supporting Ped, steel with steel fronts	42	\$825
	WP661222-SW	6/6/12 X 22" D WKS Supporting Ped, steel with wood fronts	58	\$1,430
	WP121222-SW	12/12 X 22" D WKS Supporting Ped, steel with wood fronts	62	\$1,359
	WP661222-W	6/6/12 X 22" D WKS Supporting Ped, wood with wood fronts	69	\$1,924
	WP121222-W	12/12 X 22" D WKS Supporting Ped, wood with wood fronts	65	\$1,544

